

Atlas 4 part mixertap



5 Year warranty Terms and Conditions

In the unlikely event that you should experience any defect in the materials or workmanship of your new Abode mixer within FIVE years of purchase, the purchaser's sole remedy shall be the replacement (at the manufacturer's discretion) of all or any part of the product that is defective. All working parts and valves are guaranteed for a period of TWO years from purchase. Decorative surface finishes and O-rings are guaranteed for ONE year from the date of purchase provided that our advice concerning care has been observed and no scouring agents have been used.

This is provided that the mixer has been used for normal domestic purposes in the UK and that the care, installation and maintenance instructions have been observed. The warranty extends to the original purchaser only. You should retain a copy of your dated invoice as proof of purchase to validate any claims under this guarantee.

Marks, scuffs and scratches caused by improper installation or accidental damage are not covered by this guarantee. Neither are shade variations or any

Care Instructions for your Kitchen Sink Mixer

To maintain the appearance of this tap, ensure that it is regularly cleaned only using a clean, soft damp cloth. A solution of warm water and a mild liquid detergent may be used where necessary, and then the fitting rinsed thoroughly and wiped dry. Any other cleaning action will invalidate your warranty.

If the mixertap has a diffuser it should be unscrewed and cleaned periodically in warm water.

Abrasive cleaners, scouring cleaners and acidic cleaners **must not be used** under any circumstances. Avoid contact with all solvents (including chlorinated solvents, ketones or acetones as these may result in surface deterioration or etching). Also avoid contact with any harsh household chemicals such as oven cleaners, drain cleaners, rust removers, paint strippers and toilet bowl cleaners, bar keepers friend or Brasso.

Please leave these instructions for your customer.

damage or defect caused by incorrect installation or abuse of the fitting.

As we are continuously improving and developing our range of products, finishes & colours, in the event of a valid claim, we may not be able to provide an identical replacement for the defective product throughout the guarantee period. Where an identical product is no longer available, we will supply the nearest equivalent from our then current product range. In assessing your claim, we must be given the opportunity to inspect the product as installed prior to removal. Any product returns must be packaged as received and complete.

No other warranties, express or implied, are made, including merchantability or fitness for a particular purpose. Under no circumstances shall the manufacturer be liable for any loss or damage arising from the purchase, use or inability to use this product, or for any special, indirect, incidental or consequential damages. No liability is accepted for consequential damage to other household fixtures, fittings or furnishings arising from this claim, even if attached to the product. No installer, dealer, agent or employee of Abode Home Products Limited has the authority to modify the obligations or limitations of this warranty.

Parts and Contents

Key	Description	Qty
A	Handles	2
B	Upper metal washers	2
C	Upper rubber washers	2
D	Valve bodies	2
E	Handle grub screws	2
F	Valve shrouds	2
G	Upper fixing nuts	2
H	Rubber horseshoe	1
I	Metal horseshoe	1
J	Flexible spout hose	1
K	Lower rubber washers	2
L	Lower metal washers	2
M	Lower fixing nuts	2
N	Hot & Cold flexible pipes	2
O	Spout body	1
P	Spout base	1
Q	Upper spout seal	1
R	Studded rod	1
S	Spout fixing nut	1
1	Spray head	1
2	Non return valve	1
3	Large Rubber Seal	1
4	1/2" spray head connector	1
5	Spray head base	1
6	Upper metal washer	1
7	Upper fixing nut	1
8	Upper rubber washer	1
9	Spray head chamber	1
10	Lower rubber washer	1
11	Lower metal washer	1
12	Lower fixing nut	1
13	Flexible nylon hose	1
14	Small rubber seal	1
15	4 way 'T' & flexible hose	1
16	Hose weight screws	2
17	Hose weight	2

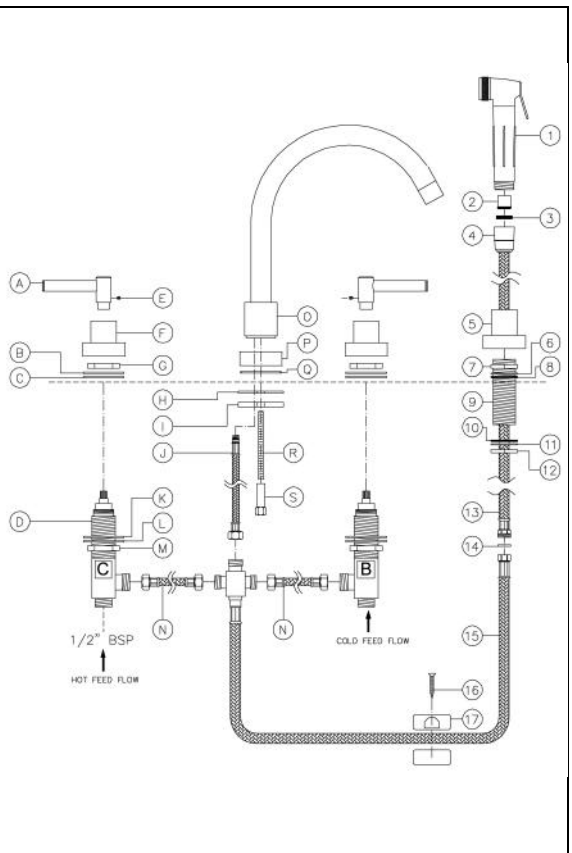

Installation Instructions:

Preparation

Before installing the new mixer it is essential that you thoroughly flush through the supply pipes in order to remove any remaining solder, swarf or impurities from your system. Failure to carry out this simple procedure could cause problems or damage to the workings of the mixertap. All parts should be removed from their packaging and inspected for any transport damage prior to installation.

We strongly recommend installing particle filters and isolation valves to both the hot and cold feed pipes in an accessible position. This will help to prevent premature failure of the valves and ease any future maintenance.

Shut off your water heating system and ensure that your mains stopcock is closed. Open the lowest hot and cold taps in the house and allow the water to run until the cold-water storage tank and pipes are fully empty. Please note, the hot water storage cylinder (if applicable) will always remain full.

This mixertap requires 4 x 35mm \varnothing tap holes, if replacing an existing tap, remove the tap & clean the end of the feed pipes using wire wool the tap hole area should be free from dirt and sealant. If this tap is to be fitted through a surface thicker than 15mm then the rear of the surface for the two outer tap holes should be rebated with a 50mm \varnothing recess.

For the handles to face outwards when in the off position install the valve bodies (I) labeled B & C as shown. For the handles to face forwards in the on position reverse the locations of the valve bodies.

Loosely position the tap and tail pipes to check if any alteration to the existing pipework is required, if this is the case do this now.

Installation

1. Screw the spout fixing stud (R) into the base of the spout (O).
2. Screw the flexible spout pipe (J) into the base of the spout (O).
3. Pass the base (P) then upper seal (Q) over the fixing stud (R) and tail pipe (J) and locate it centrally on the base of the spout (O).
4. Place the spout assembly (O) onto the sink or worktop and pass the tail pipe (J) and studded rod (R) through the center taphole.
5. Pass the rubber horseshoe (H) and then metal horseshoe (I) over the fixing stud (R) and around tail pipe (J).
6. Fasten the fixing nut (S) securely onto the fixing stud (R) fixing the spout into its correct location.
7. Screw the lower fixing nut (M) onto the valve body (D), pass the lower metal washer (L) then lower rubber washer (K) over the valve body (D).
8. Pass the valve body (D) through the tap hole from the underside; now place the upper rubber seal (C) and upper metal washer (B) onto the valve body.
9. Loosely screw the upper fixing nut (G) onto the valve body (D). Screw the valve shroud (F) fully onto the valve body. Now tighten the upper fixing nut (G) to the valve shroud (F) then tighten the lower fixing nut (M) fixing the valve body into position with the valve body outlet facing towards the spout.
10. Securely connect the tail pipe (N) to the outlet on the valve body (D).
11. Push the valve base (F) over the valve shroud (F) flush to the sink or worktop.
12. Push the handle (A) onto the valve body spindle (D), turn the valve into the on or off position and remove the handle. Replace the handle in the correct position then tighten the grub screw (E) to fix the handle in place.
13. Repeat steps 7 – 12 for the second valve body.
14. Screw the spout hose (J), hot & cold flexible pipes (N) to the 4 way 'T' (15) as shown.
15. Push the non-return cartridge (2) into the hand spray head (1) in the direction shown.
16. Screw the flexible hose connector (4) onto the hand spray head (1) ensure the small rubber seal (3) is between the two parts.
17. Remove the lower rubber washer (10), lower metal washer (11) and lower nut (12). Adjust the remaining nut and washers so they are flush with the bottom of the base plinth (5).
18. Pass the spray head chamber (9) through the worktop or sink from the top. Replace the lower rubber washer (10), lower metal washer (11) and lower nut (12) spray head chamber (9). Once the part is central to the tap hole, tighten nut (12) to fasten.
19. Pass the flexible hose (13) through the base plinth (5) from the top.
20. Screw the flexible steel hose (15) to the Nylon hose ensuring to place the small seal (14) between the two connectors.
21. Fit the lead weight (17) using screws (16) around the nylon flexible pipe at its lowest point.
22. Connect the valve bodies (D) to the water supplies using ½" BSP x 15mm compression fittings or similar.

Note: the hose weight is designed to pull the hose straight after use; it will not pull the spout head automatically back into the spout and will have to be returned by hand.

After installation

Once you have visually checked the new fittings and connections, ensure that all taps are closed except the new mixer tap which should be left open. Turn on the water supply at the mains stop cock. As the system starts to refill, check carefully for leaks. Once you are fully satisfied that there are no leaks, turn on the water heating. Clean the tap to remove any marks created during installation as instructed then place the cloth bag that has been provided to protect the tap until it is ready for use.



Important Technical Data

Minimum operating pressure 0.4 bar
Maximum operating pressure 5.5 bar*

Maximum hot water temperature 70°C*
Recommended hot water temperature 46°C

Note: If these temperatures or pressures are exceeded, even for short periods, damage can result. In these instances a thermostatic mixing or pressure reducing valve should be installed.

All Abode taps are either WRAS approved or manufactured in accordance with recognised European standards. Please ensure that your Abode Kitchen mixer is fitted in accordance with Local Water Byelaws.

These installation guidelines have been prepared for your direction and you must exercise due care at all times. We do not accept responsibility for problems that may occur through improper installation. Whilst assembling the tap take care not to accidentally loosen any screwed assemblies.

Abode is a registered trademark of Abode Home Products Limited.

Manufacturers Product Reference



©Abode
4/2005

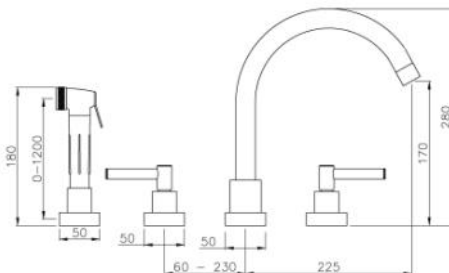

abode

Abode Home Products Limited, Unit15, Monckton Road Ind. Est, Denby Dale Road, Wakefield WF2 7AL.
Tel: 01924 202010 Fax: 01924 202012 www.abodedesigns.co.uk

All errors and omissions excepted.